

M4-11 MIESZKANIE JEDNOPOKOJOWE

IV P

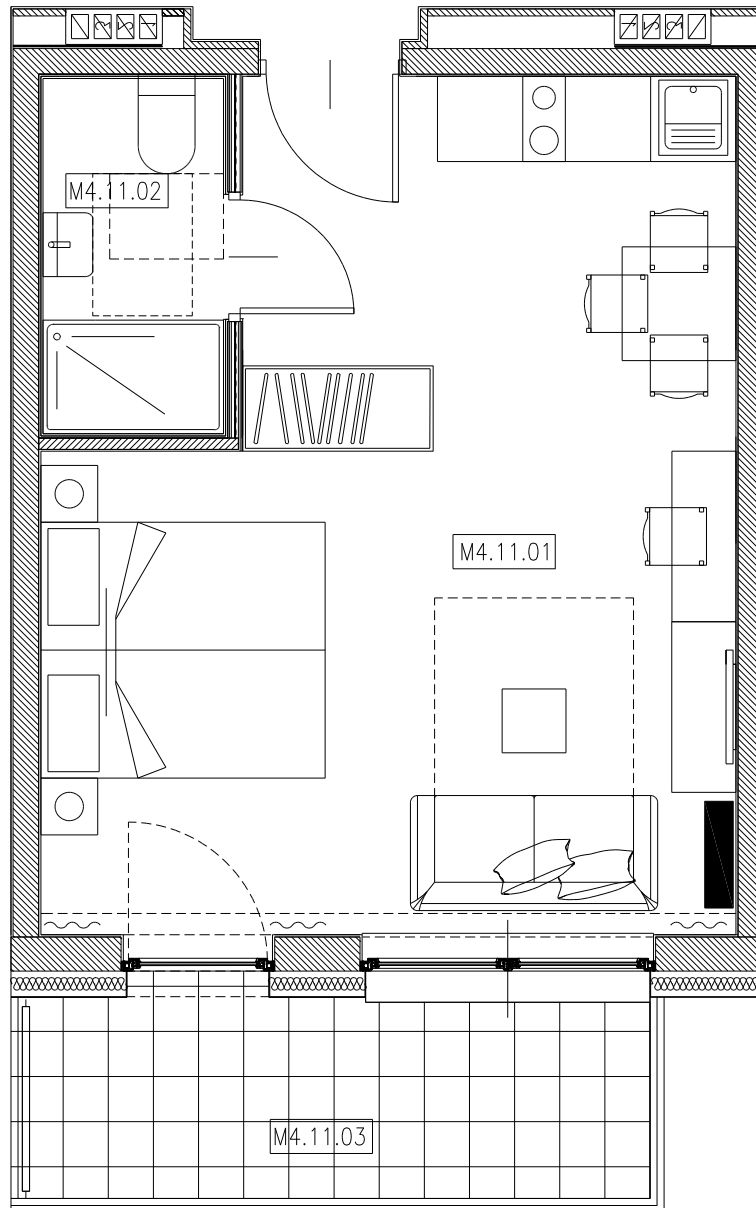

M4.11.01	POKÓJ Z ANEKSEM KUCH.	PARKIET	25,76m ²
M4.11.02	ŁAZIENKA	P.CERAM.	3,20m ²
			28,96m ²
M4.11.03	BALKON		6,36m ²

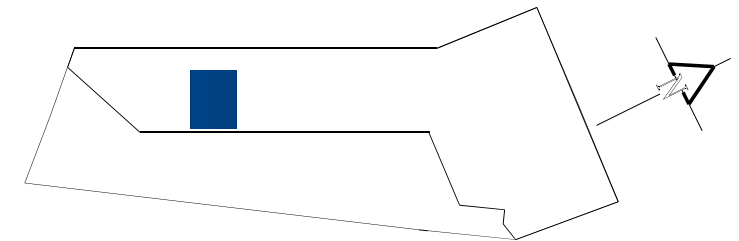

GRZEGÓRZECKA 15